

**MEFE**  
MITCHELL ENGINEERING  
FOOD EQUIPMENT PTY LTD

## Installation Manual



### Automatic Sensor Tap Tube Design Wall Mounted

CAT 67305

CAT 67305B

CAT 67305G

CAT 67306

Chrome Plated

Matte Black

Gold Chrome Plated

Revision 1

## Product Description

- This sensor tap is designed to turn on with sensor activation and off when hands are removed.
- Features a micro-computer infrared sensor control module, low consumption microprocessor chip with stable performance and high anti-interference. The PCB electronic control module is double sealed and coated by a high performance waterproof membrane, then sealed with epoxy resin.
- Automatically calibrates sensing range according to the environment and stores this into the electronic chip.
- A water saving aerator is used in the faucet to prevent water splash back and allow for a soft flow.
- Supplied with both AC 240V Transformer and DC 6V Battery Pack.
- The faucet has been precisely manufactured and tested, ensuring the quality of the product satisfies international standards.

## Pre-Install Instructions

Please choose an appropriate basin before installation, avoid basins with strong reflective surfaces.

Please prepare water supply pipe and water-proof socket (for electricity type).

**Please ensure all pipes have been flushed for at least 60 seconds and are clear of dirt and impurities** (water must be clear).

Installation must be in accordance with the National Plumbing and Drainage standard – AS/NZS 3500.

### Required Tools

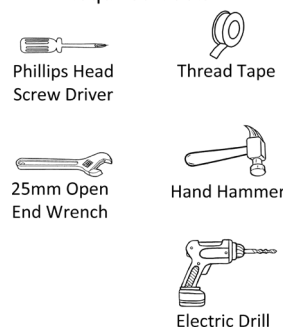

## Sensing Range

The sensor tap will automatically calibrate the sensing range when first connected to power. Please ensure the tap has been installed in the correct and final position before connecting to power. When connected to power the sensing light will flash indicating it is in programming mode, please do not interfere or obstruct for at least 60 seconds.

## Specifications

<b>Power</b>	AC 240V or DC 6V 4 x AA alkaline batteries* (batteries not supplied)	<b>Installation Diameter</b>	Single hole (32mm)
<b>Battery Life</b>	150,000 cycles	<b>Response Time</b>	Less than 0.7 seconds
<b>Sensing Range</b>	<b>Products before SN: 11044</b> Default approximately 10cm <b>Products including and after SN: 11044</b> Default approximately 10cm Reprogrammed with remote achieves min 0 to 5 or max 0 to 20cm**	<b>Water Stop Protection (Auto Shut Off)</b>	Approx. 30 seconds
<b>Working Temperature</b>	1°C - 60°C	<b>Flow Rate</b>	Less than 3 L/s at 0.3Mpa
<b>Working Pressure</b>	0.07Mpa—0.7Mpa	<b>Ambient Humidity</b>	95% or less
<b>Inlet Size</b>	BSP 1/2" (DN15) male thread	<b>Faucet Body Material</b>	Standard #65 brass, chrome plated

\* AA Alkaline batteries must be maximum 14mm in diameter. If it seems you are forcing the batteries please choose a different brand as AA batteries can range between 13.5 and 14.5mm in diameter. We recommend Energizer Max E91 AA batteries.

\*\* To reprogram sensing range use optional remote 673-100R.



### WaterMark Certified

Australia and New Zealand WaterMark certified with approved licence number WM-022559.



### 6 Star WELS Rating

This guarantees that the product is in accordance with the standard set under the National Water Efficiency Labelling and Standards and has the highest possible water efficiency rated 6 Stars. Licence number 1718.



### DDA Compliant

Suitable for use for AS 1428.1 design and access requirements when installed in reference to AS 1428.1 2009 Amendment 1 and the intent of the Disability Discrimination Act (DDA).

**Installation of CAT 67305 (Mortar (Wet) Installation)**

**1** Prepare PVS drain pipe in advance according to the size above. Put PVC elbows into the PVC Pipe.

PVC elbow  
 Ø36mm  
 Ø40mm  
 50cm  
 (40mm PVC Drain pipe Self-prepared)

**2**

45mm  
 60mm  
 PVC drains  
 Water supply pipe  
 200mm  
 400mm

Slot the wall according to the figure then place the PVC elbow into the slot

**3**

Wall  
 Tiles  
 Cement mortar  
 PVC drains  
 Water supply pipe

Fix the PVC pipe with cement mortar, Once this is complete, you can start tiling.

**4**

Install the mounting plate on the elbow.

**5**

First thread the signal wire into Pipe  
 Then insert the hose into Pipe

**6**

Tighten the decorative cover

Proceed to Step 4 of Drywall Installation on next page

## Installation of CAT 67305 (Dry wall Installation)

### Step 1

Take the fixing plate out of the faucet

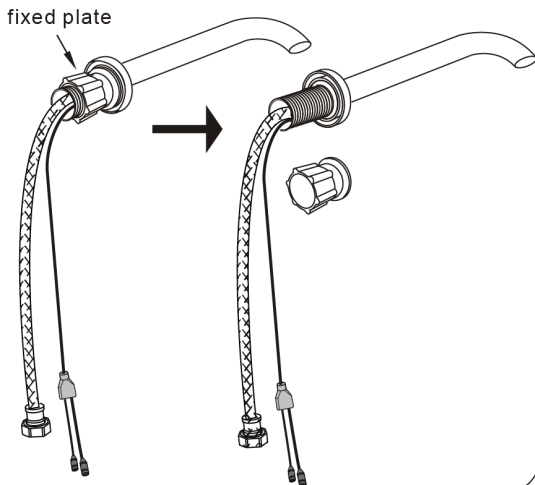

### Step 2

Install the fixing plate

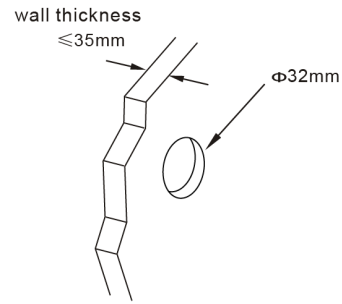

### Step 3

Route the hose and signal wires through the fixing plate and wall plate

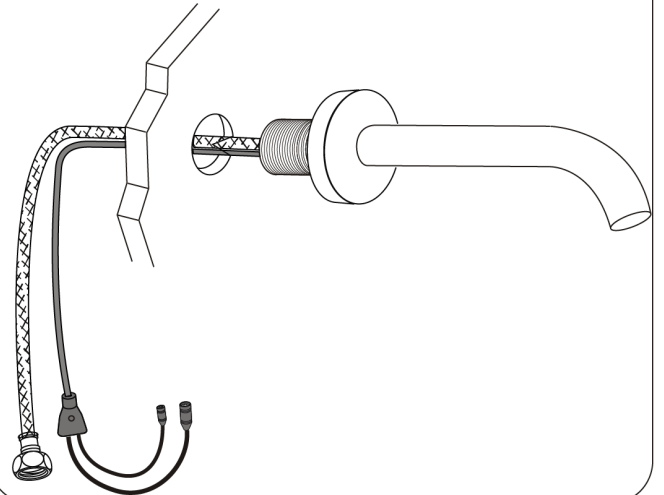

### Step 4

Fix control box

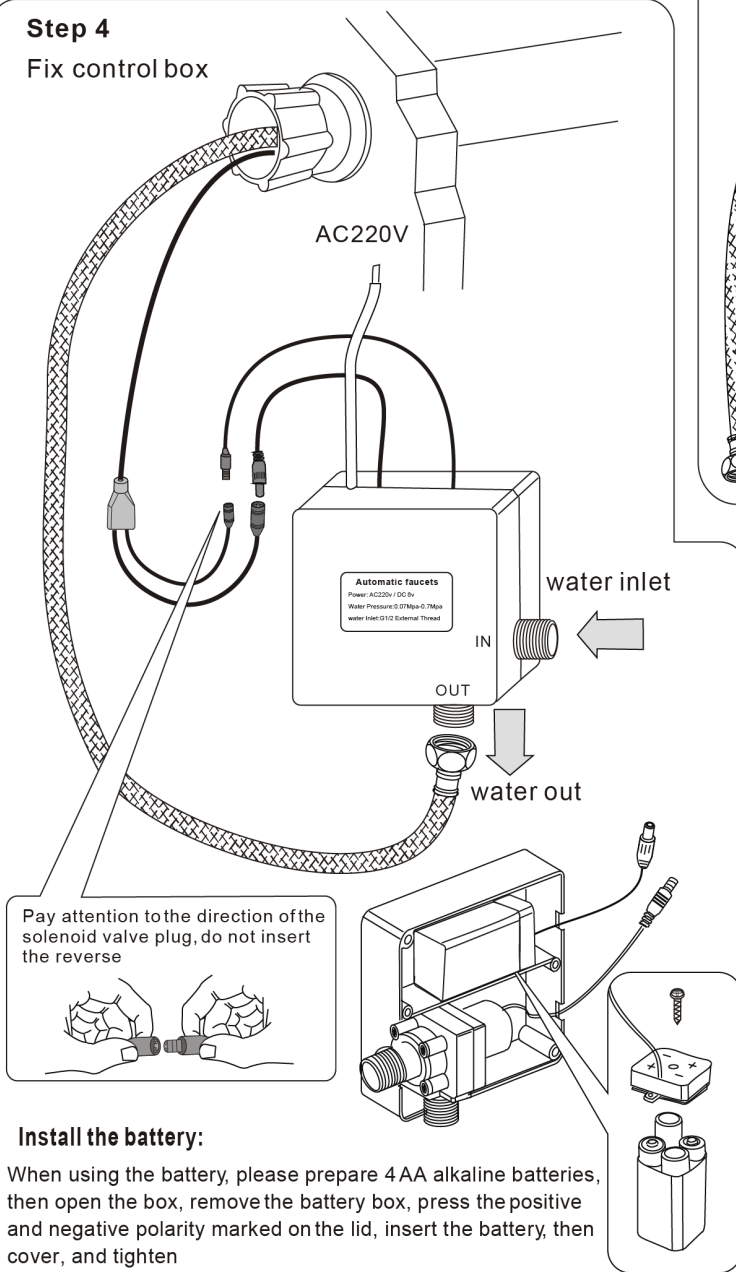

Insert the sensor cable into the socket on the control box. And tighten the nut. When the power is turned on, the LED on the sensor controller flashes. It can be used after the light goes out

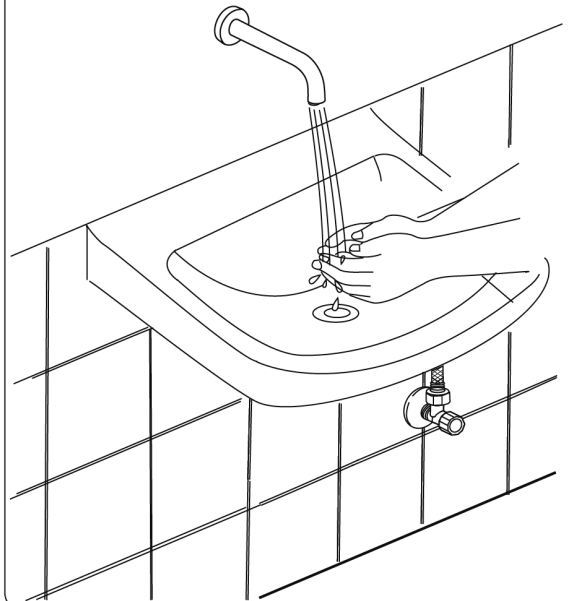

## Installation cont.

### Optional: Hot and Cold Mixer

To control water temperature you will require the following to connect to your hot and cold water supply:

2 x Watermarked Braided Hoses (flexible) with a DN15 nut on both ends (**673-058L** 120cm / **673-058** 100cm)

1 x Watermarked Mixer Valve (**CAT 67 M2**)

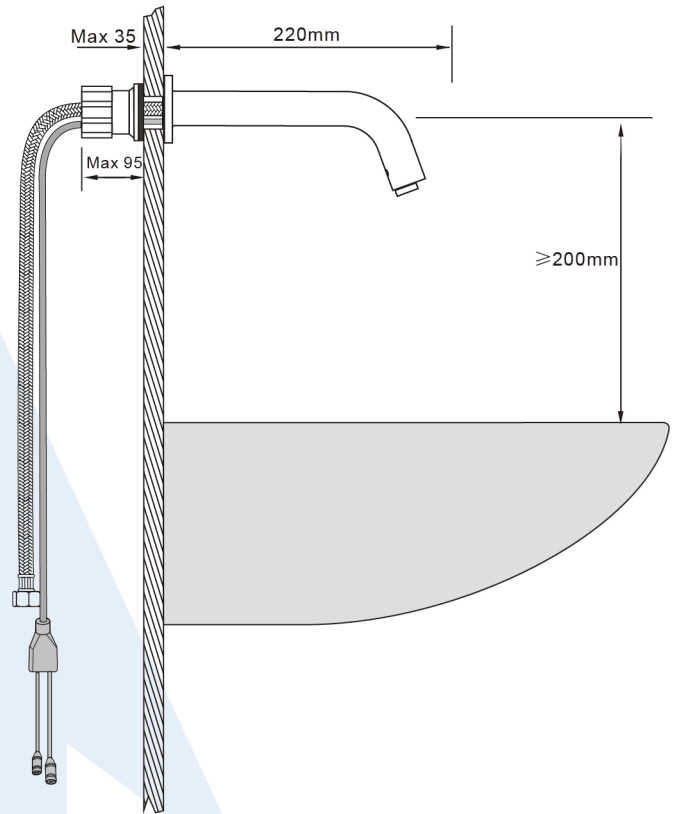
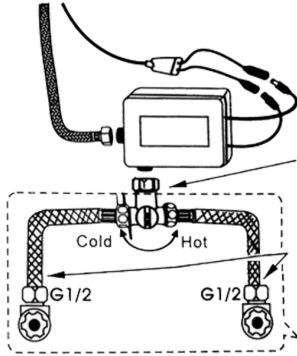

## Fault Check

Our sensor tap range is primarily divided into three components: the sensor, the solenoid valve, and the power supply.

The solenoid valve and power supply are universal and interchangeable parts across our range of same type taps. The sensor is specific to each spout type.

If you have other sensor taps or spare parts available it can be helpful to trouble shoot by swapping parts until the faulty part is identified.

Issue	Cause
No water flow	Check the power supply: if using batteries, carefully check the correct polarity of the batteries and replace. The sensor light should flash indicating the tap is entering programming mode.
No water flow	Check the sensor: After confirming power is OK, if the sensor light does not flash, replace the sensor.
No water flow	Check the solenoid valve: place your hands under the faucet, you should hear a click of the solenoid valve indicating the sensor is working normally. This means water is not supplied or unable to flow. Check the solenoid valve for obstruction—the solenoid diaphragm may be blocked. Opening and cleaning the solenoid may be necessary, or replace the solenoid valve.
Low water flow	Check the solenoid valve: A leaking faucet with a constant slow flow indicates the diaphragm is not sealing due to debris or it may be cracked or torn. Replace the diaphragm or the complete solenoid valve.
Intermittent water flow / sensing	Check the sensing range: This is most likely caused by a failure to program sensing range correctly due to interference from a reflective basin. We recommend you remove power for 2 minutes, then reconnect and allow the sensor to adjust to a short sensing range.
Water does not stop flowing	Check the solenoid valve: If the faucet does not stop flowing it may be that the solenoid valve is faulty and should be replaced. The diaphragm is not sealing due to debris or it may be cracked or torn. Clean, replace the diaphragm or the complete solenoid valve.

## Cleaning and Maintenance

Regular cleaning is essential to keep your tap looking its best.

**Do not** rinse the control box with water.

**Do not use abrasive or chemical cleaners** (including chlorine to clean the faucet as this can dull or damage the lustre and finish of the tap).



**Wash only** in soap water and dry with a clean soft towel or microfibre cloth.

When cleaning the general area please ensure you **protect the faucet from any cleaning acids or fluids as this can discolour or remove the chrome plating where applicable.**

The filter screen on the solenoid valve inlet should be cleaned regularly to avoid excessive blockage and obstruction caused by impurities resulting in low water flow.

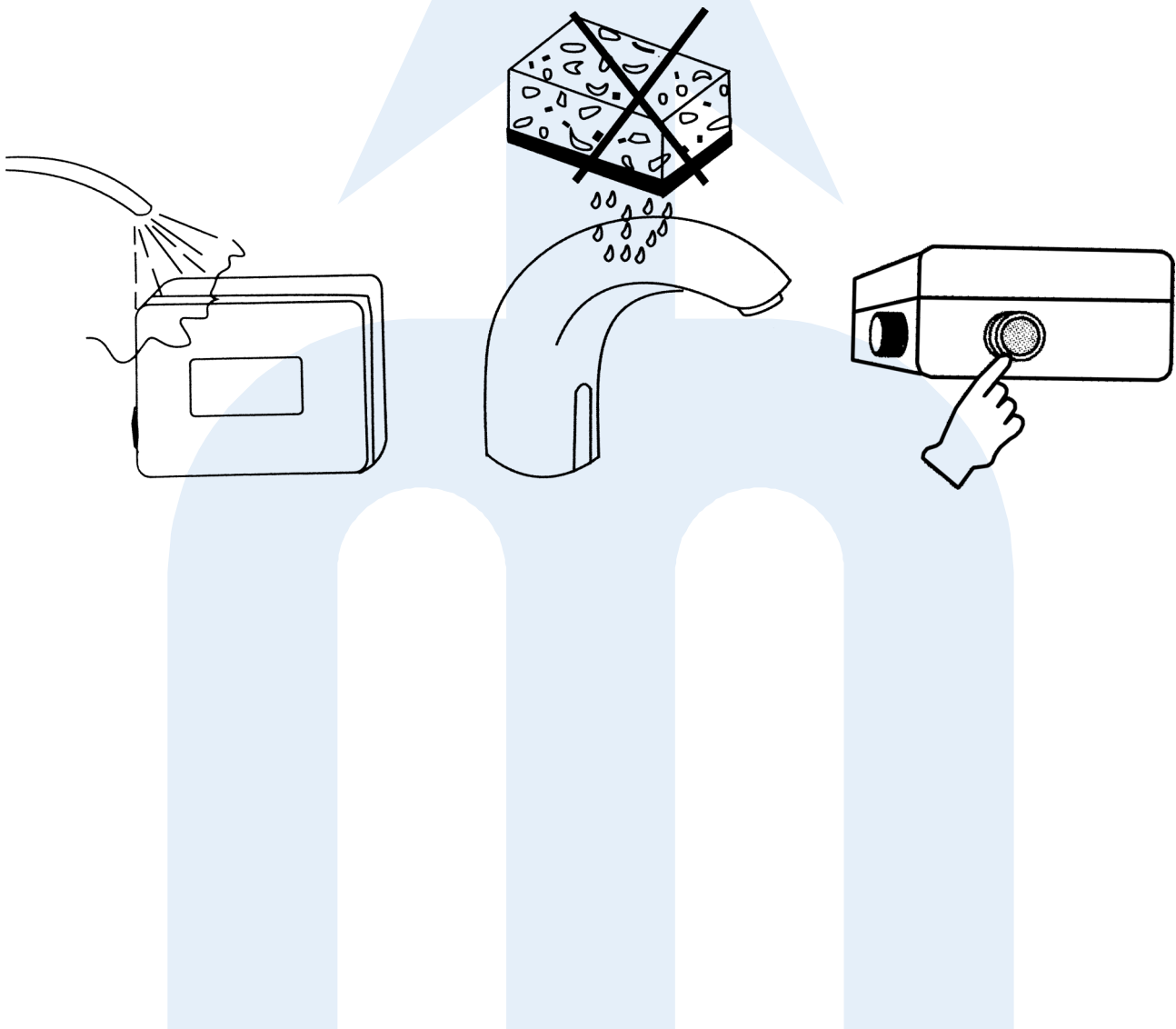



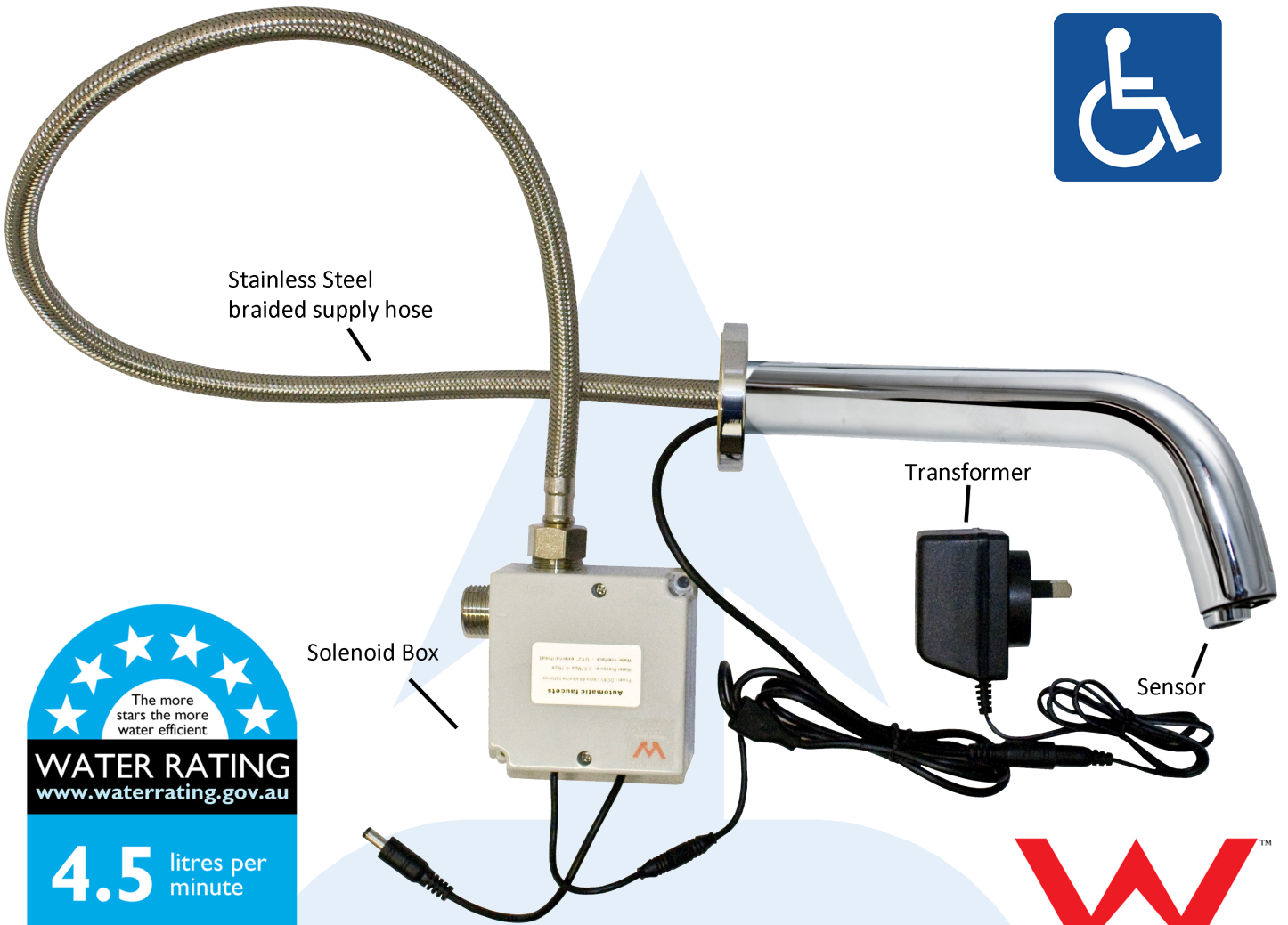

The more stars the more water efficient

**WATER RATING**  
www.waterrating.gov.au

**4.5** litres per minute

In accordance with AS/NZS 6400

**Licence No. 1718**  
Mitchell Engineering Food Equipment Pty Ltd

**WaterMark**  
WM - 022559  
AS/NZS 3718

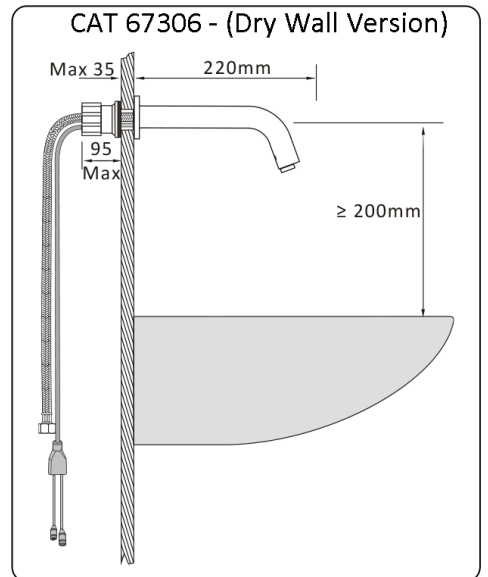
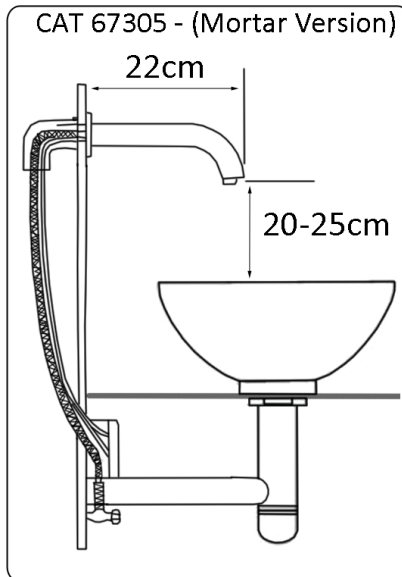
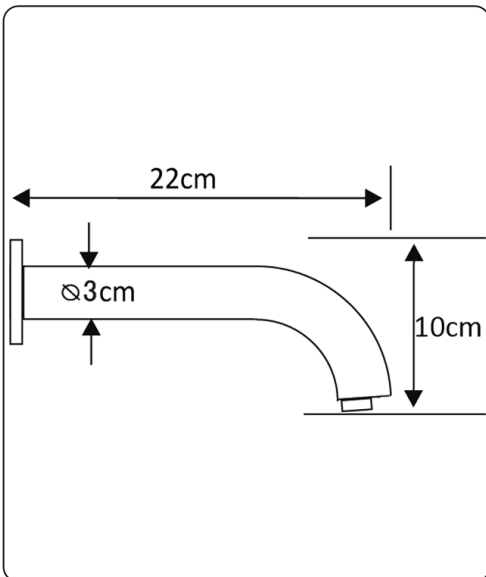

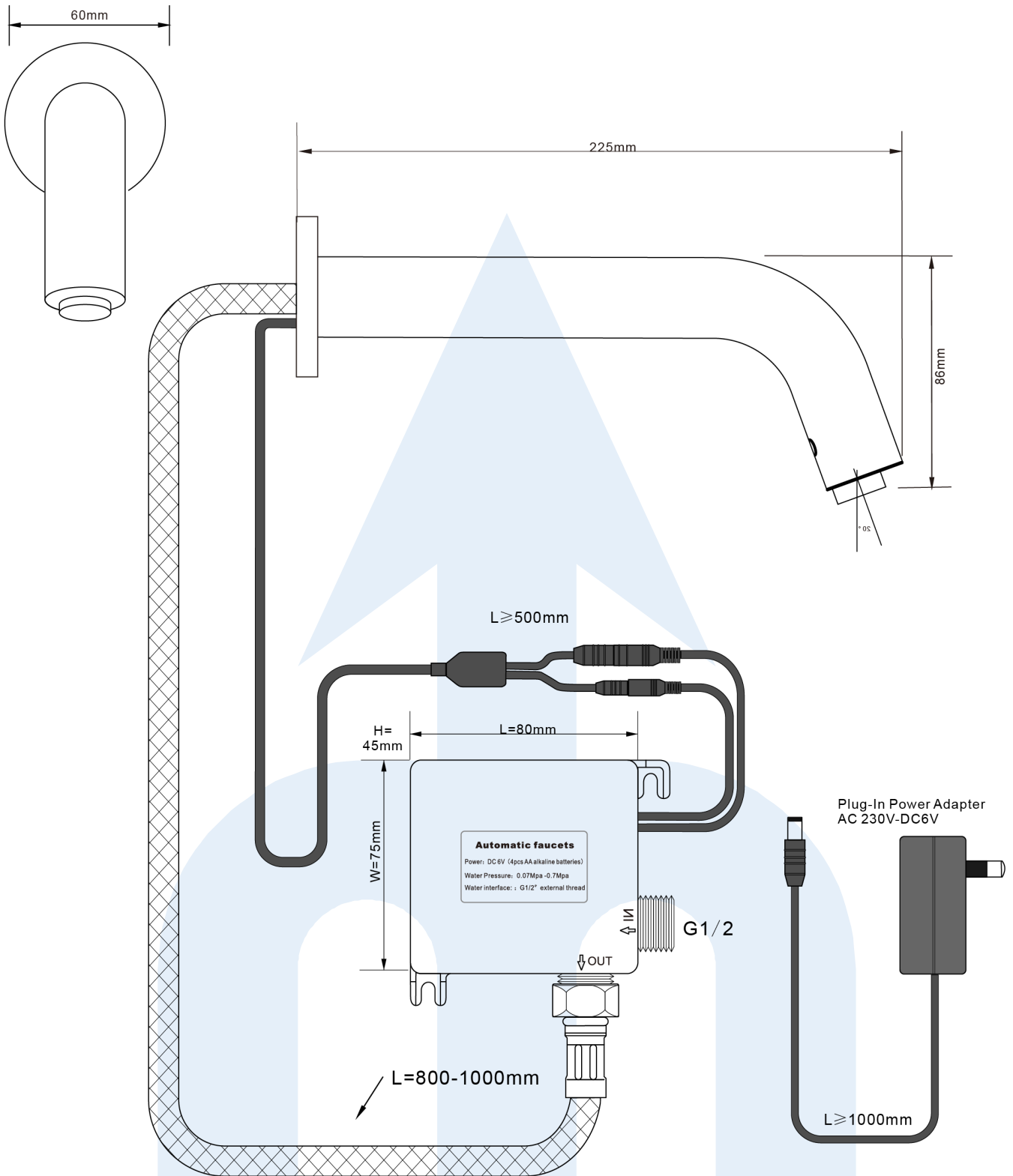

WALL SENSOR TAPS

DIS.:CAT 67305 - CAT 67306

Formato **A4**



Scale **1:2**

MEFE - MITCHELL ENGINEERING FOOD EQUIPMENT Pty Ltd Tel:1800 669 006 info@mefe.com.au

MEFE—Mitchell Engineering Food Equipment Pty Ltd  
 23 Storie Street Clontarf QLD 4019 Australia  
 www.mefe.com.au | info@mefe.com.au

Page 8  
 +617 3283 4536  
 Free AU 1800 669 006



# CAT 67305 Automatic Faucet Exploded View

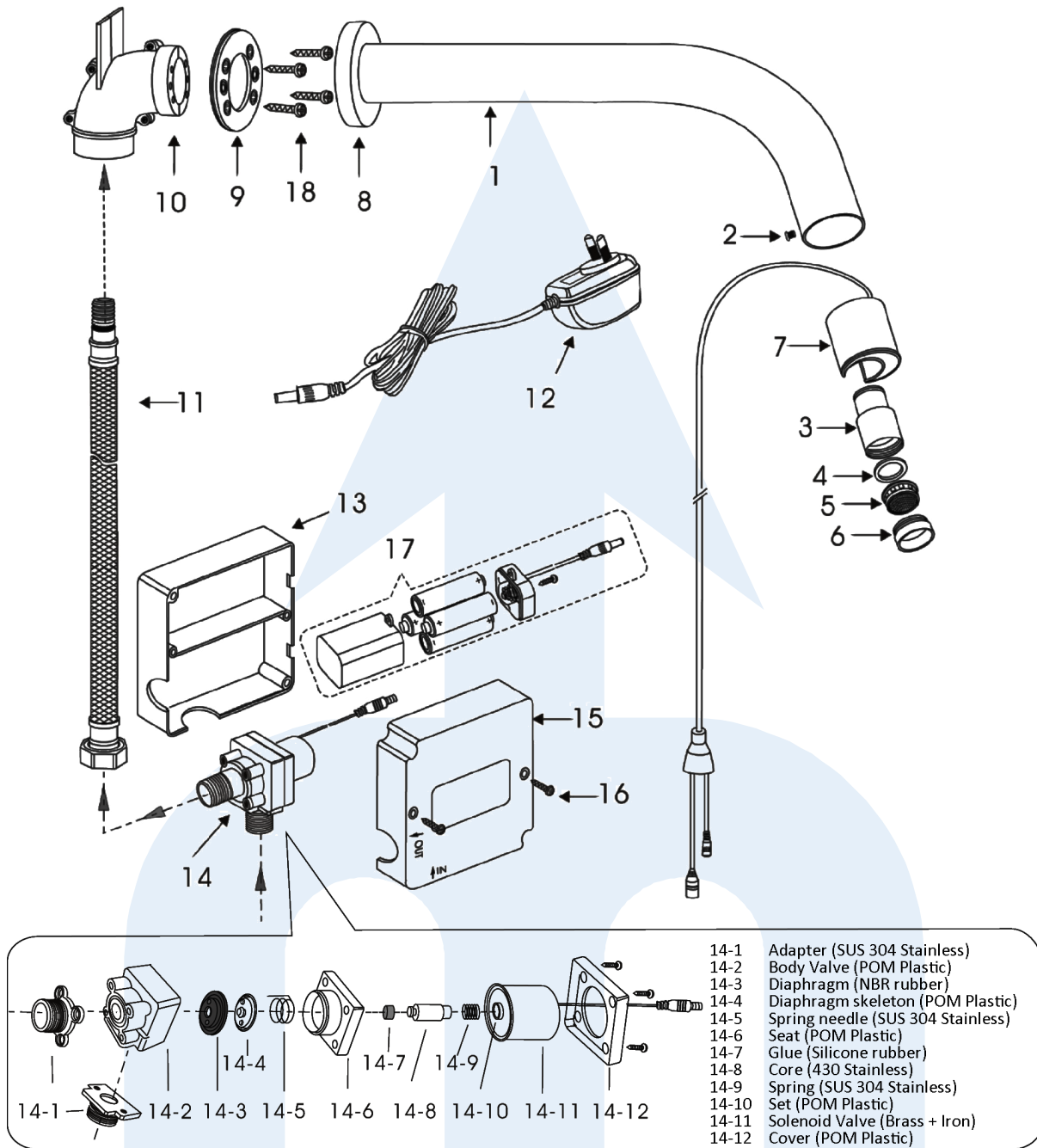

- 14-1 Adapter (SUS 304 Stainless)
- 14-2 Body Valve (POM Plastic)
- 14-3 Diaphragm (NBR rubber)
- 14-4 Diaphragm skeleton (POM Plastic)
- 14-5 Spring needle (SUS 304 Stainless)
- 14-6 Seat (POM Plastic)
- 14-7 Glue (Silicone rubber)
- 14-8 Core (430 Stainless)
- 14-9 Spring (SUS 304 Stainless)
- 14-10 Set (POM Plastic)
- 14-11 Solenoid Valve (Brass + Iron)
- 14-12 Cover (POM Plastic)

No.	Part #	Description	Material	No.	Part #	Description	Material
1.	673-050	Faucet Body	Brass	10.	673-057-1	PVC Elbow	PVC Plastic
2.	673-045	Screw	SUS 304 S Steel	11.	673-058L	Braided Hose	SUS 304 Stainless
3.	673-054c	Spout Adapter	Brass CW602N	12.	679-128	Power Adaptor	Electronic Hardware
4.	673-054B	Rubber Mat	NBR Rubber	13.	679-120	Housing	ABS Plastic
5.	673-054	Aerator	POM Plastic	14.	679-122	Solenoid Valve	POM Plastic + SUS 304 S Steel
6.	673-054a	Spout Shell	Brass CW602N	15.	679-120	Housing	ABS Plastic
7.	673-106	Sensor	Electronic Hardware	16.	679-127	Screw	SUS 304 Stainless Steel
8.	673-055	Cover	Brass CW602N	17.	679-121	Battery Box	ABS Plastic
9.	673-056-1	Mounting Plate	Brass	18.	679-123	Screws	201 Stainless

# CAT 67306 Automatic Faucet Exploded View

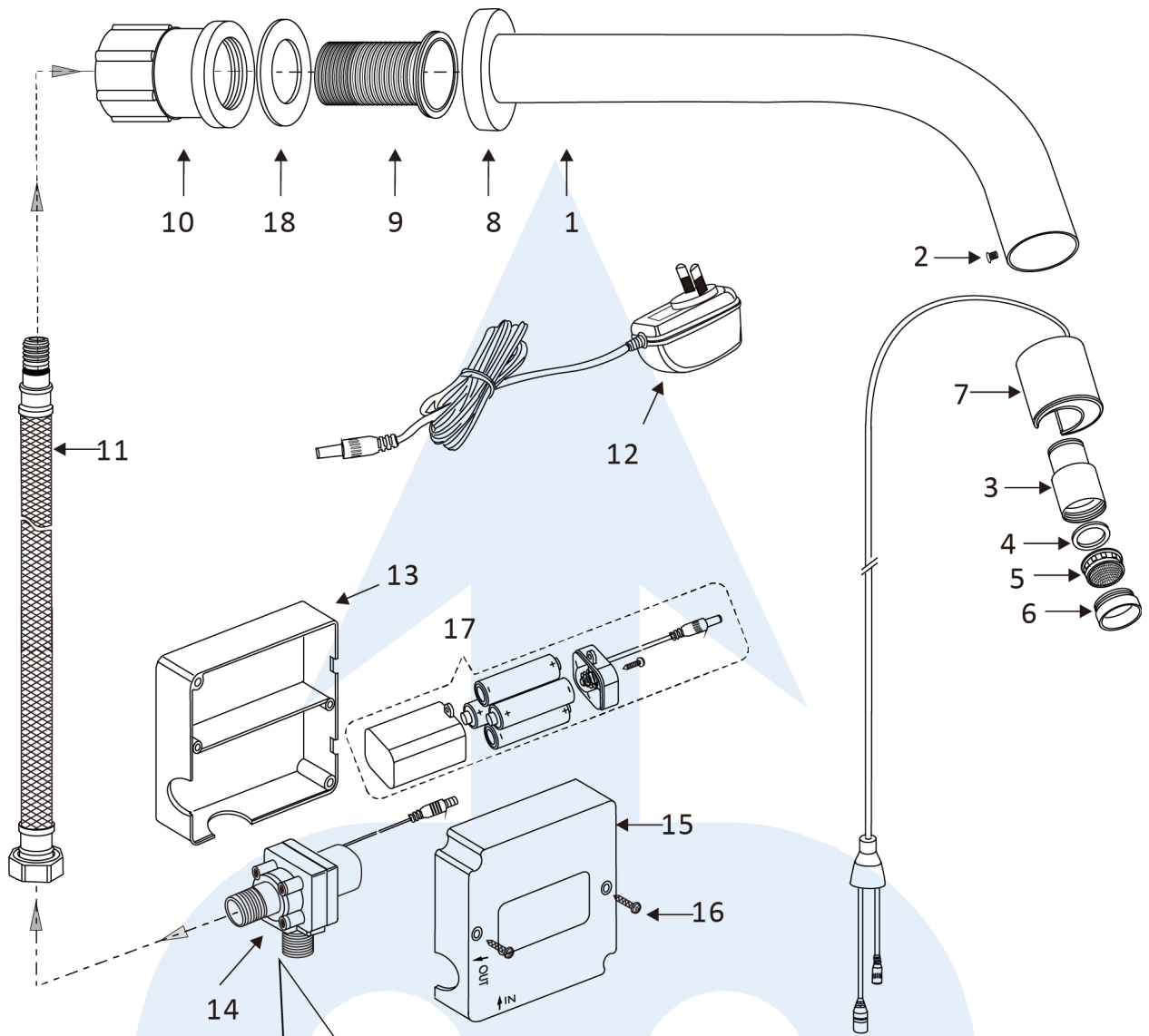

- 14-1 - Adapter (SUS 304 Stainless)
- 14-2 - Body Valve (POM Plastic)
- 14-3 - Diaphragm (NBR rubber)
- 14-4 - Diaphragm skeleton (POM plastic)
- 14-5 - Spring needle (SUS 304 Stainless)
- 14-6 - Seat (POM Plastic)
- 14-7 - Glue (Silicone rubber)
- 14-8 - Core (430 Stainless)
- 14-9 - Spring (SUS 304 Stainless)
- 14-10 - Set (POM plastic)
- 14-11 - Solenoid valve (Brass+Iron)
- 14-12 - Cover (POM Plastic)

No.	Part #	Description	Material	No.	Part #	Description	Material
1.	673-050	Faucet Body	Brass	10.	673-057-2	Plastic Copper Nut	Plastic + Brass
2.	673-045	Screw	SUS 304 S Steel	11.	673-058L	Braided Hose	SUS 304 Stainless
3.	673-054c	Spout Adapter	Brass CW602N	12.	679-128	Power Adaptor	Electronic Hardware
4.	673-054B	Rubber Mat	NBR Rubber	13.	679-120	Housing	ABS Plastic
5.	673-054	Aerator	POM Plastic	14.	679-122	Solenoid Valve	Noted in Breakdown
6.	673-054a	Spout Shell	Brass CW602N	15.	679-120	Housing	ABS Plastic
7.	673-106	Sensor	Electronic Hardware	16.	679-127	Screw	SUS 304 Stainless Steel
8.	673-055	Cover	Brass CW602N	17.	679-121	Battery Box	ABS Plastic
9.	673-056-2	SS Bolts	SUS 304 S Steel	18.	679-123-1	Rubber Gasket	NBR Rubber